



**MEETING ROOM CUBICLE | SAPPHIRE WALL SYSTEM | 9'X7'X8'H**



**\$14,150.21**

- **Actual Footprint Size:** 9'5"W x 7'4"D x 95"H
- **Individual Workspace Size:** 9'W x 7'D x 95"H
- **Panels Pictured:**
  - **Fabric:** None
  - **Laminate:** White
  - **Glass:** Tempered Glass
- **Door Pictured:** Locking Glass Swing Door
- **Trim Pictured:** Silver
- **Worksurface Pictured:** Black Oak Laminate



This system is completely customizable - View the fabric options to the left

1. Due to screen resolution and lighting variations color may look different in person from what you see in the image.

Contact our designers to create your dream office 1-888-993-3757 or e-mail [sales@skutchi.com](mailto:sales@skutchi.com)

**SKU:** SAPW-01-9x7x95-EX1-FA-SSDR

## GALLERY IMAGES

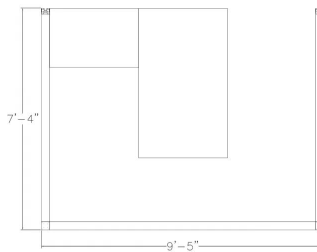

## PRODUCT DESCRIPTION

### Why Buy Our Meeting Room Cubicles?

The **Sapphire Wall System** offers meeting room cubicles which can be built to a variety of shapes and sizes. This highly versatile panel system--with heights ranging over 7', 8' or 9'ft--is completely freestanding. No permanent attachments to your floor or ceiling are needed.



In other words, all of our meeting rooms are fully demountable. It usually takes less than a day to assemble (depending on the size of the room).

You can also customize the panels of our meeting room cubicles in a variety of ways; choose all glass or mix in laminates and fabric panels. We offer 15 different color fabric and laminate options. The **Sapphire Wall System** is a beautiful, modular wall alternative to traditional drywall construction-- which can take weeks of construction and downtime.

### **What Comes With This Product?**

The 9' x 7' x 95"H meeting room pictured on this page includes locking swing doors and includes free shipping. Additionally, we offer built-in "raceway tracks" along the bottom of our panel walls to provide hidden electrical and data network management. Just as important, you can change or replace individual panels when needed instead of the entire wall.

In short, our meeting room cubicles can be customized in many ways to suit almost any business or office. In most cases, there's no need to deal with landlords or city permits for its construction. If your business ever needs to relocate then simply take the meeting room cubicle with you to your new location and reconfigure as needed.

### **What Else?**

The meeting room cubicles of our **Sapphire Wall System** are fully compatible with any items available in our [Sapphire Cubicle System](#), which includes workstations, furniture, and accessories such as file storage, shelving, overhead storage, desks, chairs, and padded benches, paper racks, and accessory rails. Give us a call to customize yours today!