



**2-PERSON CALL CENTER CUBICLE WORKSTATION | SAPSLIM CUBICLE COLLECTION |  
SAPPHIRE CUBICLE COLLECTION | 6X4X65"H**



**\$4,211.70**

- **Overall Footprint Size:** 6'1"W x 8'2"D x 65"H
- **Individual Workstation Sizes:** 3'W x 4'D x 65"H
- **Features Include:**
  - 1-1/4" thick panels
  - Complementary brushed aluminum frame
  - Choose between translucent polycarbonate, Sea Salt Laminate or clear acrylic for the **SAPslim** panels (shown in frosted polycarbonate)
  - Coordinates with the **Sapphire Cubicle System** for a uniformed working environment
  - Choose from (4) laminate and 15 fabric options for the **Sapphire Cubicle** panels



(shown in White Laminate, Silver Fabric and Charcoal Fabric)

- o 1" thick laminate worksurface
- o Choose from our 8 in-stock desktop laminates (shown in Sea Salt)
- o (4) Silver Box Legs
- o (2) Wally Mobile File Pedestals
- o Due to screen resolution and lighting variations color may look different in person from what you see in the image.

**SKU:** SLM-SAPC-CC-05-6x4x65H

## GALLERY IMAGES

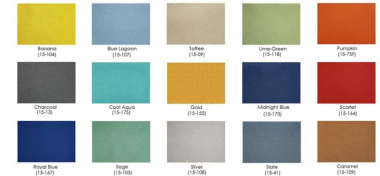
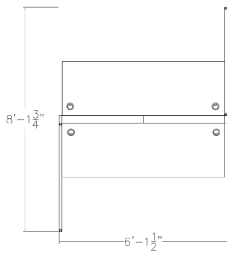

## PRODUCT DESCRIPTION

The SAPslim Cubicle System is our newest, entry-level cubicle/divider product line. This versatile cubicle divider panel system was designed with affordability and practicality in mind. Its lightweight, modular construction makes it easy to quickly assemble in any work environment.



**Skutchi Designs, Inc.**

**(888) 993-3757**  
**sales@skutchi.com**

This typical consists of our SAPslim Cubicle System panels in frosted polycarbonate as well as our Sapphire Cubicle System panels in White Laminate, Silver fabric and Charcoal fabric.

Nearly any part of the configuration you see pictured here can be added to, modified, or re-imagined. The SAPslim Cubicle System panels can be switched out with Sea Salt Laminate or clear acrylic panels.

There are also plenty of inexpensive extras you can add to the SAPslim Cubicle System.

Let SKUTCHI Designs Inc. answer any questions you may have or help with your office design needs today.