

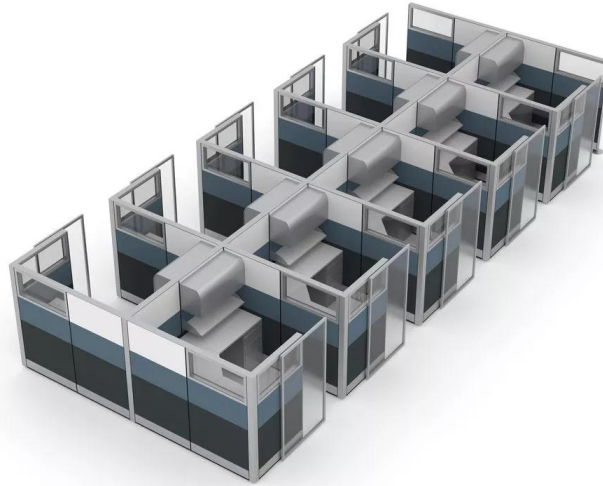

**10-PERSON CUBICLE WORKSTATIONS WITH SLIDING DOOR AND STORAGE | SAPPHIRE
CUBICLE SYSTEM | 6' X 6' X 65" H**



\$55,290.18

- **Actual Footprint Size:** 12'11"W x 31'2"D x 65"H
- **Individual Workspace Size:** 6'W x 6'D x 65"H
- **Panels Pictured:**
 - **Fabric:** Slate and Charcoal
 - **Laminate:** White
 - **Glass:** Clear Tempered
- **Worksurface Pictured:** White
- **Door Pictured:** Non Locking Sliding Door
- **Trim Pictured:** Silver



- **Storage Shown:** Silver Pedestal, 36" W Overhead Bin, and 36" W Bookshelf
- Due to screen resolution and lighting variations color may look different in person from what you see in the image.

The configuration pictured is completely customizable! View our fabric and laminate options to the left.

Contact one of our designers today to create your dream office at 1-888-993-3757 or e-mail sales@skutchi.com

SKU: SAPC-LC01-6X6X65H-SLD.DOOR

GALLERY IMAGES

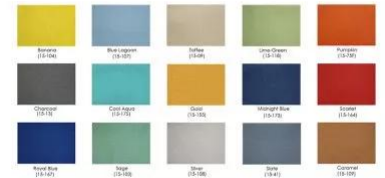
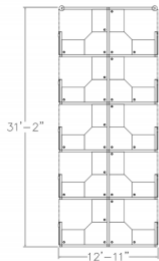

PRODUCT DESCRIPTION

Why Buy Our 10-Person Cubicle Workstations?

Are you looking for 10-person cubicle workstations? The [Sapphire Cubicle System](#) is our premier



cubicle workstation product line. This modular, commercial-grade cubicle system is both versatile and durable. Its lightweight construction makes it a practical investment for any office or work environment.

Because of its scalability and design, any number of 10-person cubicle workstations can be made.

Also, this cubicle system features a variety of choices for the panels (multi-colored fabrics, patterned laminates, and tempered glass) and offers panels reaching 39", 52", and 65" in height. And don't forget, this cubicle system also offers electrical cord/data networking cable conduits along the base of each panel to hide cable clutter.

What Comes With This Product?

The 10-person cubicle workstation pictured on this page consists of our **Sapphire Cubicle System** divider panels with L-shaped worksurfaces. You can select alternate colors for the panels, the overall dimensions of the workspace sizes, the height of the panel divider walls, and the shape of the worksurfaces if you'd like.

There are many additional accessories you can add to your cubicle workspaces such as locking overhead storage bins, pedestal cabinets, accessory racks, monitor arms, paper trays, writing utensil holders, and many other features to complete your project. You can even replace the L-shaped worksurfaces with our [Quantum Sit-to-Stand](#) desks as an upgrade.

What Else?

Finally, it's important you have a clear understanding of all options, accessories, and preferences available for our 10-person cubicle workstation. For this reason, we suggest you contact *SKUTCHI Designs Inc.* today. Whatever questions you have, we can answer. Our goal is to make ordering your customer service cubicle as easy as possible.